

HEADLIGHT ASSEMBLY: EXPLODED VIEW

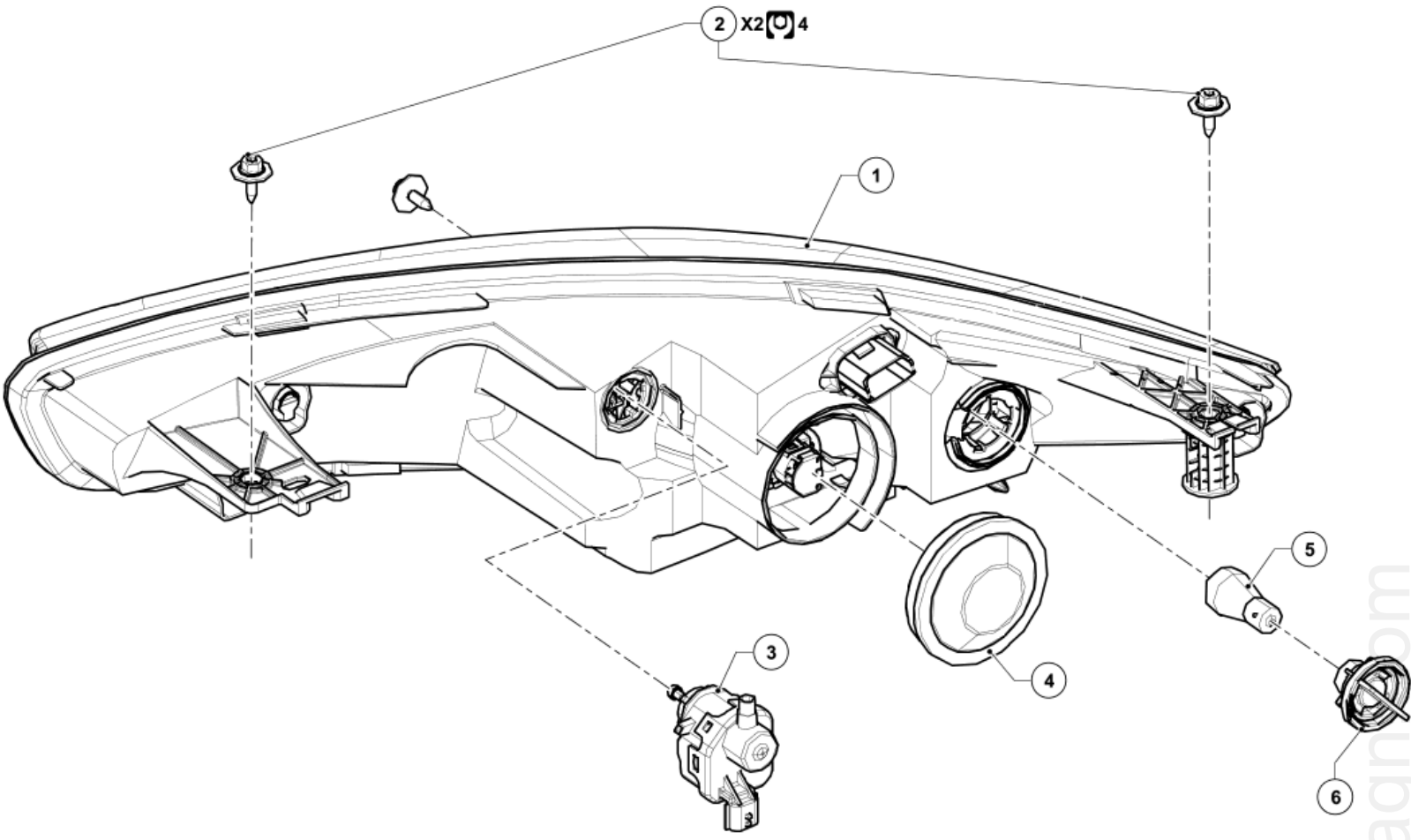

Illustration key: Description .
For fastenings with no specified tightening torque values, refer to the Table of Standard TorquesTightening torques: General information .

Marks	Designations	Informations
1	Headlight	(see Headlight: Removal - Refitting)
2	Headlight screw	
3	Headlight beam adjustment actuator	(see Remote headlight beam adjustment actuator: Removal - Refitting)
4	Rear cover-protector headlight	
5	Direction indicator bulb	
6	Holder front turn signal lamp	

HEADLINING:REMOVAL-REFITTING



Note, one or more warnings are present in this procedure



WARNING



■ To avoid all risk of damage to the systems, apply the safety and cleanliness instructions and operation recommendations before carrying out any repair:

- [Airbag and pretensioners: Precautions for the repair](#) ,
- [Vehicle: Precautions for the repair](#) .

Locations and specifications (tightening torques, parts to always be replaced, etc.)([see 71A, Body internal trim, Roof trim assembly: Exploded view](#)) .

REMOVAL

1. REMOVAL PREPARATION OPERATION

WARNING



DANGER: Risk of serious injury due to short-circuiting or untimely triggering of an electrical system (pyrotechnic components, windscreen wiper motor, fan assembly etc.) following possible re-supply of the 12-volt supply circuit by the voltage converter.

Please follow the instructions regarding lockout of the 12 V supply circuit.

If the procedure fails, do not continue with your task and ask an employee who is qualified and authorised to work on a high-voltage onboard network to perform fault finding [Vehicle: Precautions for the repair](#) .

■ Disconnect the 12V supply circuit [12 V supply circuit : Lockout - Removal of lockout](#) .

■ Move:

- the front door seals,
- the rear door seals,
- the luggage compartment seal.

■ Unclip the B-pillar lower trims([see 71A, Body internal trim, Interior body side trim assembly: Exploded view](#)) .

- Remove the front seat belts [Front seat assembly: Exploded view](#) .
- Unclip the B-pillar upper trims [\(see 71A, Body internal trim, Interior body side trim assembly: Exploded view\)](#) .
- Remove [Rear bench seat assembly: Exploded view](#) :
 - the rear bench seat base,
 - the rear seat belts,
 - the rear bench seatback.
- Remove:
 - the luggage compartment carpet,
 - the rear end panel lining.
- Remove [\(see 71A, Body internal trim, Interior body side trim assembly: Exploded view\)](#) :
 - the rear inner sill upper trim,
 - the rear door sill lining,
 - the rear parcel shelf side trims,
 - the rear wheel arch interior trims,
 - the rear quarter panel trims,
 - the windscreen pillar trims.
- Remove [\(see 71A, Body internal trim, Roof trim assembly: Exploded view\)](#) :
 - the sun visors,
 - the grab handles.
 - the interior rear-view mirror,
 - the interior light.
- Remove:
 - the windscreen wiper arms [Wiping and washing: List and location of components](#) ,
 - the scuttle panel grille [Scuttle panel grille: Removal - Refitting](#) ,
 - the scoop under the scuttle panel grille [Scoop under the scuttle panel grille: Removal - Refitting](#) ,
 - the windscreen [Windscreen: Removal - Refitting](#) .
- Remove:
 - the cover of the centre seat belt return mechanism bolt,
 - the centre seat belt return mechanism mounting.

2. REMOVAL OPERATION

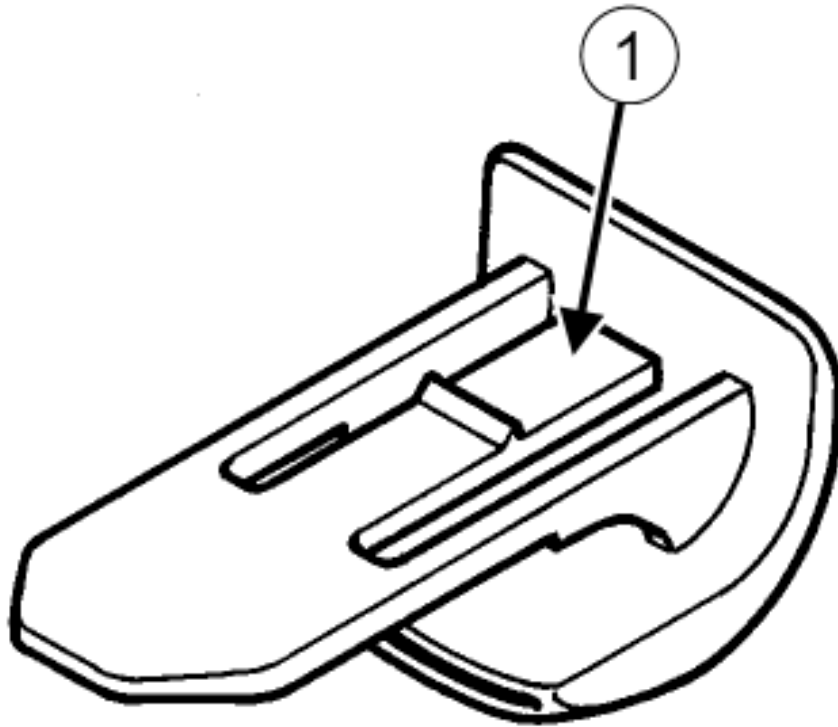

97193

cardiagn.com

■ Remove [\(see 71A, Body internal trim, Roof trim assembly: Exploded view\)](#) :

- the rear clips by pressing on the clip(1) using a small flat-blade screwdriver.
- the headlining by removing from the front (this operation requires two people).

REFITTING

1. REFITTING OPERATION

■ Proceed in the reverse order to removal.

❏ Disconnect the 12V supply circuit [12 V supply circuit : Lockout - Removal of lockout](#) .



Repair-70x02x04x02-01x37-1-32-1.xml



XSL version : 3.02 du 22/07/11