

CENTRE FLOOR FRONT CROSS MEMBER: REPLACEMENT



Note, one or more warnings are present in this procedure



WARNING

DANGER: HIGH VOLTAGE VEHICLE.



Risks of serious burns or electric shocks that may prove fatal.

Before carrying out any work on the vehicle, it is essential that you follow the instructions regarding vehicle lockout. This work must be carried out by an employee who is qualified and authorised to work on a high-voltage onboard network [Vehicle:](#)

[Precautions for the repair](#) .

Lockout the vehicle [Vehicle: Lockout - Removal of lockout](#) .

1. COMPOSITION OF THE SPARE PART

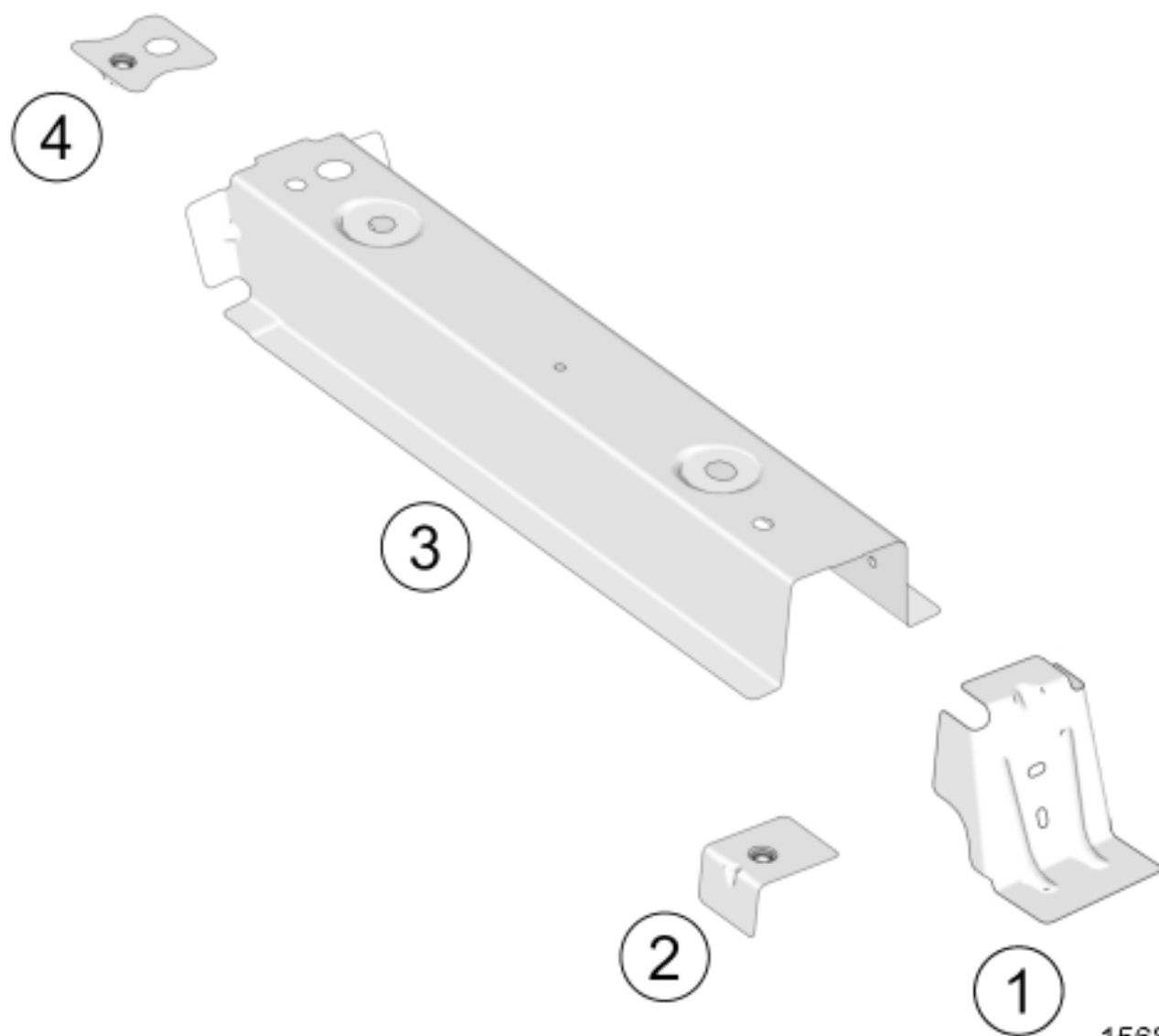

156868

